



## 52 Woodford Avenue

Plympton, Plymouth, PL7 4QW

£320,000



Lovely semi-detached Stanbury-built family home in the heart of Woodford, with a garage, shared driveway & an addition hardstand to the front. The accommodation comprises an entrance hall & cloakroom, lounge, open plan kitchen/diner & conservatory with 3 bedrooms & a family bathroom. To the rear there is a landscaped garden - perfect for entertaining.



## WOODFORD AVENUE, PLYMPTON, PLYMOUTH PL7 4QW

### ACCOMMODATION

Composite front door, with double-glazed lead-light panel, opening into the entrance hall.

### ENTRANCE HALL 12'5" x 6'0" (3.8 x 1.84)

Staircase rising to the first floor landing with storage cupboard and door opening to the cloakroom. uPVC double-glazed window to the side. Door opening into the lounge and the open plan kitchen/diner.

### CLOAKROOM 4'7" x 2'5" (1.41 x 0.75)

Fitted with a matching suite comprising a wall-mounted wash handbasin and close-coupled wc. Obscured uPVC double-glazed window to the side.

### LOUNGE 13'11" x 12'2" into the bay (4.26 x 3.71 into the bay)

Feature fireplace with multi-fuel burner set into the chimney breast. uPVC double-glazed bay window to the front.

### KITCHEN/DINER 18'6" x 8'7" (5.65 x 2.63)

An open plan room with matching base and wall-mounted units incorporating a roll-edged laminate worktop with an inset sink unit, mixer tap and 4-ring ceramic hob with stainless-steel extractor hood over. Integrated oven. Spaces for American-style fridge/freezer, dishwasher and washing machine. Ample space for dining table. Exposed wooden flooring. uPVC double-glazed windows to the side and rear elevation. uPVC double-glazed door opening into the conservatory.

### CONSERVATORY 13'0" x 8'1" (3.97 x 2.48)

Constructed in in uPVC beneath a polycarbonate roof. uPVC double-glazed windows to the side and rear. uPVC double-glazed door opening to the rear garden. Power and lighting. Plumbed with a radiator.

### FIRST FLOOR LANDING

Doors providing access to the first floor accommodation. uPVC double-glazed window to the side.

### BEDROOM ONE 13'9" x 11'6" (4.21 x 3.52)

uPVC double-glazed bay window to the front.

### BEDROOM TWO 12'4" x 10'7" (3.78 x 3.25)

uPVC double-glazed window to the rear overlooking the garden.

### BEDROOM THREE 6'10" x 6'7" (2.09 x 2.01)

uPVC double-glazed window to the front.

### BATHROOM 7'10" x 7'4" (2.4 x 2.25)

Fitted with a matching suite comprising a corner bath with multi-jet system, shower cubicle, pedestal wash handbasin and close-coupled wc. 2 obscured uPVC double-glazed windows to the side.

### OUTSIDE

The property is approached via a shared driveway which runs alongside the house to the single garage. There is also additional parking on the hardstand to the front. To the rear is an enclosed garden with a paved patio and steps leading up to a lawn. A path leads to a further paved patio seating area.

### GARAGE 7'10" x 16'5" (2.39 x 5.01)

Up-&-over door. Power and lighting. Storage area with windows to the side and rear. Courtesy door opening to the garden.

### COUNCIL TAX

Plymouth City Council

Tax Band: C

### SERVICES

The property is connected to all the mains services: gas, electricity, water and drainage.

### WHAT3WORDS

///faster.tests.strike

## Area Map



## Floor Plans

GROUND FLOOR



1ST FLOOR

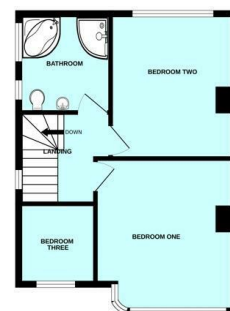

## Energy Efficiency Graph

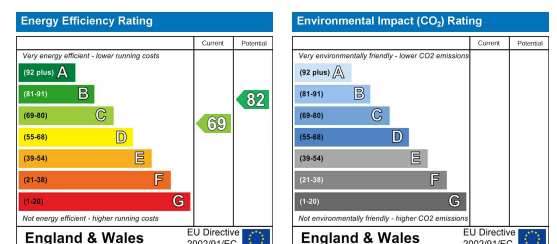

These particulars, whilst believed to be accurate are set out as a general outline only for guidance and do not constitute any part of an offer or contract. Intending purchasers should not rely on them as statements of representation of fact, but must satisfy themselves by inspection or otherwise as to their accuracy. No person in this firm's employment has the authority to make or give any representation or warranty in respect of the property.